

play all of the speakers, but one at a time. (If the Random Operation Switch is turned ON, then the speakers will play one at a time in a random order. If the Random Switch is OFF, they will play in a sequential order. To operate the unit for **Speaker Operation**, set **Switch 6** in **Mode Settings** as follows:

Switch 6	Mode
OFF	One speaker at a time
ON	All speakers at one time

PROGRAMMING EXAMPLE

Recording Switches: 1, 3, 5 and 6 to "ON" position
Results: Plays Sounds 1, 3, 5 & 6

Mode Switches:

- 1 = "OFF" position Time Off Interval is set to
- 2 = "ON" position Medium, every 1 to 4 minutes
- 3 = "ON" position Operates during daylight
- 4 = "OFF" position hours only
- 5 = "ON" position Sounds in random, non-sequential order
- 6 = "ON" position All speakers broadcast simultaneously

VOLUME CONTROL

The unit has a volume control dial on the front panel of the unit. Turning the dial toward low will result in reduced sound output and rotating the dial toward high will result in an increase in sound output.

CAUTION: Take care when turning the dial since the unit may be in an inactive state when the dial is rotated. It could then reactivate at a very high level of sound which could be painful to your ears.

POWER SWITCH

The power switch enables the unit to operate. Slide the switch to the ON position to start the unit. If you turn the unit OFF, be sure to leave it off for about 30 seconds before turning it back on to allow the electronics to properly reset. To fully disconnect the unit, unplug the power adapter from the electrical outlet or disconnect the battery cable from the 12-volt battery.

TROUBLESHOOTING

PROBLEM	SOLUTION
Unit is on, but no sound is heard	<ul style="list-style-type: none"> • Check volume settings • Check time of operation settings. • Check that at least one bird is selected to play.
Unit is on, but plays the same bird over and over, regardless of settings	<ul style="list-style-type: none"> • Reset the unit by turning it off for 30 seconds and then back on.
Unit is not operating properly in the DAY or NIGHT mode	<ul style="list-style-type: none"> • Double check Mode switch settings • Make sure photocell is not obstructed. • Make sure the photocell is not affected by bright lights in either the front or the back of the unit.
Unit does not function properly when connected to a 12 volt battery	<ul style="list-style-type: none"> • Check battery condition • Turn power switch on the unit to the OFF position. Reconnect the battery, wait 30 seconds, then switch the unit back on

Successful Long-Term Behavior Modification

Product success takes time to build. Bird and pest habits may take several days or weeks to break. Follow all suggestions for maximum efficacy. "Instant" tests do not replicate natural conditions and give no indication of the unit's success with the infestation.

Prepare for Successful Critter Control

Bird-X, Inc. has been recognized worldwide as the critter and bird control x-perts for 40 years. We have become experts through extensive experience and research. As a result, we are happy to analyze problems and make recommendations based on each customer's specific situation and needs. In addition, we provide the following recommendations for greatest success, even before activating the repeller.

Remove inducements. Clean the area of all evidence of critters or birds: nests, fledglings, droppings, dead birds, and the residential scent. Because critters, birds and their droppings can carry many diseases, use extreme caution when removing them. Do not breathe or come into direct contact with them. If you have questions about how to do this safely, consult an expert. (Adults are likely to return to their young in order to protect them or to assist them in leaving the area.) Remove food spillage, garbage, nesting material and other appealing items.

Survey the critters and/or birds to determine flight or ground path and time patterns, entries and exits, and nesting, feeding and roosting habits. This will suggest the unit placement, speaker direction and time of operation you should choose. Make educated guesses as to where the birds or critters will go when they are repelled from their current infestation, and consider additional units to cover these alternative areas.

Maintain a clean and changing environment. Periodically clean the area of nests and droppings, relocate or reposition the unit, vary the output, or turn off the unit for a short time.

Install early, before "season" begins, as it is easier to keep pests away than to rout them out once they have established a living pattern.

Use products synergistically. Two or more different kinds of devices (this repeller plus a visual scare product and/or a roost inhibiting device) will produce a synergistic effect -- i.e., in combination, the products will yield much greater effectiveness than the one alone. Contact us for information on "companion" products.

Limited Warranty

This Critter Blaster PRO unit is warranted against defects in material and workmanship for six months from date of purchase (extended warranty available). Bird-X will replace or repair, provided defect occurs under normal use. Returns accepted only with authorization from our Chicago office.



Bird-X, Inc.
 300 N. Oakley Blvd.
 Chicago, IL 60612

312.226.2473 • solutions@bird-x.com

EPA Est. No. 075130-OR-001

CRITTER BLASTER PRO INSTRUCTIONS P/N #655-0036-00 (Rev. B)

Digital Bird Repeller



PRIOR TO INSTALLATION

Your complete Critter Blaster PRO system includes a control unit, power adapter, battery cable with clips and four speakers. Open the control unit by lifting the two latches on the side of the enclosure.

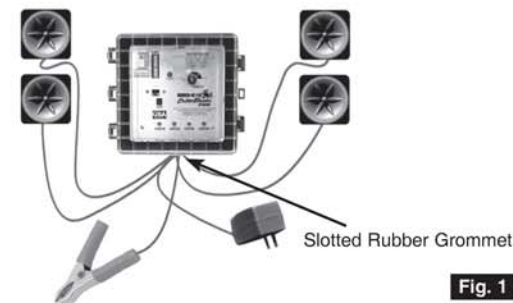

Fig. 1

Prior to operation, route the speakers and power cables from their respective jacks on the control panel down through the slotted rubber grommet in the lower part of the enclosure, as shown in Figure 1.

IMPORTANT: Be certain that the power switch is in the OFF position and the volume control is set to the minimum (LOW) volume level (counterclockwise) as shown in Fig. 2 while plugging the speaker and power cords into the control unit.

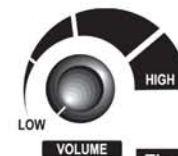

Fig. 2

INSTALLATION

Important safety-related information:

- a) Do not install the device during rain or snow conditions.
- b) Installation shall be made in such a way that a power supply and the internal part of the control unit never be subjected to water or snow.
- c) Note that a power supply powered from 230 VAC is intended for indoor use only.

- 1) Use the mounting hardware (included) to mount the control unit box to a wall, post or other vertical surface.
- 2) Plug the power adapter into an electrical outlet or attach the battery clip assembly to a 12V battery. The other end of the cable should already be plugged into the power jack located below **POWER** on the front panel of

the control unit box. An optional battery cable may be used to connect the control unit to a 12-volt battery. If this is done, first connect the black battery clip to the negative terminal on the battery and then connect the red battery clip to the positive terminal. Both the connection to the electrical outlet (or battery) and the connection of the power cable inside the control unit must be protected from dripping or splashing water. Do not set an object filled with liquids on the control unit.

- 3) It is recommended to mount the speaker(s) on a post or surface that is aimed directly and at the same level as the infested area.
- 4) Set the recording switches, mode setting switches, time-off switches, time of operation switches and random operation switches to the desired settings. (See "PROGRAMMING YOUR CRITTER BLASTER PRO" for complete details on how to program your unit).
- 5) Make sure the volume setting is set to **LOW** (all the way counter-clockwise).
- 6) Slide the power switch to the **ON** position. The unit may take a few seconds before starting.
- 7) Adjust the volume to the desired level.
- 8) Close the cover and latch shut. Ensure that the cover is properly latched closed and do not open the cover during rain or other conditions that would expose the inside of the control unit to water.

PROGRAMMING YOUR CRITTER BLASTER PRO

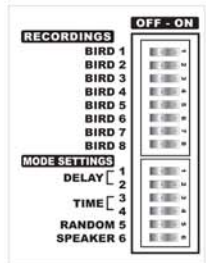

To program your CRITTER BLASTER PRO unit you will need a small screwdriver, toothpick, or other small, rigid object to move the switches in the switch array. The switch array is the switch bank located in the top left corner of the unit (under "PROGRAM"). A switch is **ON** if the switch is moved to the right-hand side. The switch is **OFF** if the switch is moved to the left-hand side.

HARASSMENT SETTING SWITCHES

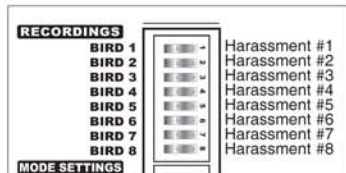

The Harassment Setting Switches are the first eight switches in the switch array. Each switch has a number to the right of it that corresponds with the harassment descriptions listed above.

Critter Blaster PRO is designed to play each selected

sound at a different randomly selected frequency each time it plays that sound. This feature is designed to add to the effectiveness of the unit and is independent of the Random Operation Switch Setting.

MODE SETTING SWITCHES

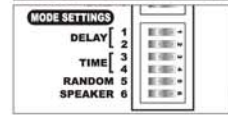

The Mode Setting Switches set the various modes of operation: such as the amount of time between playing bird distress calls, when the unit will operate (day only, night only, or 24 hours), whether the unit will operate in the random mode or normal mode, and whether the speakers will operate in sequence or simultaneously.

Switch	Mode or Function
1	Sets the Time-Off Period
2	Sets the Time-Off Period
3	Sets the Time the unit plays
4	Sets the Time the unit plays
5	Turns Random Mode On or Off
6	Sets Speaker operation sequence

DELAY SWITCHES

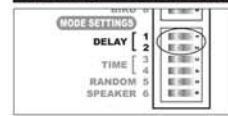

The two "Delay" or Time Off Switches are located **just below the top eight switches** in the switch array. These switches control the number of seconds or minutes between recorded sounds. The SHORT setting is appropriate for testing, but is NOT recommended for long-term success. Please note that the unit will play, for 48 seconds total, all of the selected recordings (either sequentially or non-sequentially, depending on the Random Mode) then it will go into a delay. The time the unit stays off depends on the Delay and the Random Mode settings. If the unit is operating in Random Mode, the unit will delay anywhere from the minimum value to the maximum value for that Delay setting. If the unit is not in Random Mode, it will delay only the minimum value. To set the Delay period use the following settings on switches 1 and 2 in the Mode Function settings.

Switch 1	Switch 2	Delay Period
ON	OFF	Short
OFF	ON	Medium
ON	ON	Long
OFF	OFF	Extra Long

Mode	Min	Max
Short	17 sec	50 sec
Medium	1 min	4:15 min
Long	5:00 min	10:00 min
XLong	10 min	30 min

TIME OF OPERATION SWITCHES

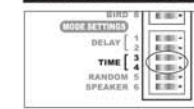

The two "Time" switches are **located just under the Delay switches** in the switch array. 'Night Only' operates the unit at night and 'Day

Only' operates the unit during the day. However, the photocell that senses the sunlight is susceptible to bright lights. Take care not to have bright lights shining towards the unit since this can prevent the unit from operating properly. In '24-Hour Mode', the unit will operate continuously, regardless of the time of day. To set the Time period for the unit to operate set switches **3** and **4** in the Mode Function settings to the following:

Switch 3	Switch 4	Mode Settings
ON	OFF	Day Only
OFF	OFF	24-Hour
OFF	ON	Night Only

RANDOM OPERATION SWITCH

The "Random" switch is the **fifth switch in the switch array**. When the Random Mode is turned ON, the unit will

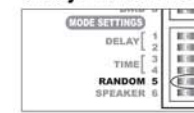

randomly play the selected recordings in non-sequential order; the Time Off Interval will be a randomly selected period of time within the

selected range (Short, Medium, Long, Extra Long); and the speakers will play one at a time in a random pattern (if the Speaker Operation switch is set to one speaker at a time - see below). When the unit is not operating in the Random Mode, it will play the selected recordings in their number order; the Time Off Interval will be the shortest time period within the selected range; and the speakers will play one at a time in a sequence from Speaker 1 to Speaker 4 (assuming the Speaker Operation Switch is set to one speaker at a time).

The Random Mode is recommended to keep critters from adapting to a preset pattern of sounds. To operate the unit in Random Mode, set **Switch 5** in Mode Settings as follows:

Switch 5	Mode Settings
ON	Random mode ON
OFF	Random mode OFF

NOTE: The unit will always play for approximately 48 seconds independent of the number of sounds that are selected.

SPEAKER OPERATION SWITCH

The **Speaker Operation** switch is the bottom switch in the Mode Settings switch array. When operating this switch, the unit will either broadcast sounds out of **one speaker at a time OR out of all speakers at the same time**. When selecting **one speaker at a time**, the unit will